



Supported Independent Living in Aspendale Gardens

Property ID: 270

Vacancies: 1



Bedrooms:
5



Bathrooms:
2



Property Owner:
Department of
Families, Fairness
and Housing (DFFH)



**NDIS Funded
SDA Design Category:**
Improved Liveability



Support provided:
Seven days per week
with sleep over
support model



Enjoy a home with two comfortable outdoor seating areas to relax in.

*Your
new home*

Features

- Open plan kitchen, dining and living area.
- Two undercover outdoor seating areas perfect for relaxing in.
- Accessible bathroom.
- Broadband internet and pay TV access available.
- Property is owned by the Department of Families, Fairness & Housing (DFFH) and staff support is provided by Scope.

Current residents

- Three male and one female resident in their 50s.
- They enjoy parties, music, movies, coffee, sport and going on walks.

Bedroom features

- Built-in robes.
- Heating and cooling.

Local area

- Close to beautiful gardens and reserves.
- Only a short drive to the beach and Aspendale train station.
- IGA supermarket is nearby.

Interested in applying?

Before applying, make sure:

- The applicant is aged 18 years or over.
- The applicant has approved SDA eligibility and NDIA funding at the appropriate level.
- The applicant has the financial means to pay rent and utilities and is prepared to sign (or a representative to sign) a residential agreement.
- The Specialist Disability Accommodation (SDA) design category is Improved Liveability.

Find out how this can be your new home

To apply or to arrange an inspection, contact DFFH on:

southvct@dffh.vic.gov.au
www.dffh.vic.gov.au

For SIL enquiries or for more details contact Scope on:

1300 472 673
contact@scopeaust.org.au



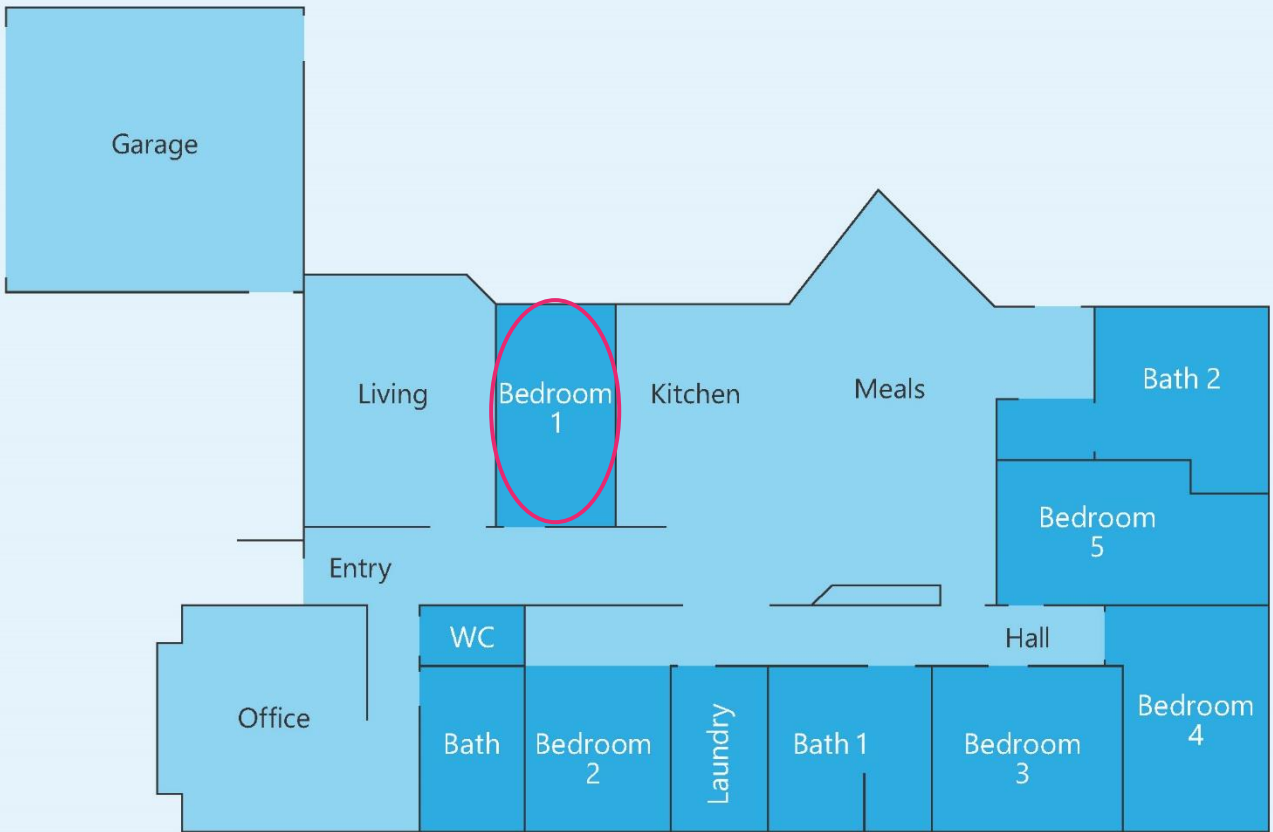

Making an enquiry

1300 472 673

VacancyEnquiries@scopeaust.org.au