



# Supported Independent Living in Bell Park

Property ID: 97

Vacancies: 1



**Bedrooms:**  
5



**Bathrooms:**  
2



**Property Owner:**  
Department of Families, Fairness and Housing (DFFH)



**NDIS Funded SDA Design Category:**  
Improved Liveability



**Support provided:**  
Seven days per week with sleep over support model



*Your  
new home*

## Enjoy living independently in this home close to the scenic Northshore Beach.

### Features

- Open plan kitchen and dining area, with a separate living room.
- Undercover outdoor seating area perfect for relaxing or entertaining.
- Property is owned by the Department of Families, Fairness & Housing (DFFH) and staff support is provided by Scope.
- Sleepover support is provided seven days per week.
- Staff have skills in communication, epilepsy and behaviour support.

### Current residents

- A mix of male and female residents aged between 40-70 years old, who are very independent and enjoy being in the community, attending day programs and working throughout the week.
- Hobbies and interests of the residents include cooking, music and travelling.
- The ideal new housemate will be independent, love to have fun, laugh and joke around, and enjoy the weekly healthy baking activities held in the house.

### Bedroom features

- Built-in robes.
- Heating and cooling.

### Local area

- Ten-minute drive to Northshore Beach.
- Several restaurants, cafes, parks and walking tracks nearby.
- Short drive to shops and train station.

### Interested in applying?

#### Before applying, make sure:

- The applicant is aged 18 years or over.
- The applicant has approved SDA eligibility and NDIA funding at the appropriate level.
- The applicant has the financial means to pay rent and utilities and is prepared to sign (or a representative to sign) a residential agreement.
- The Specialist Disability Accommodation (SDA) design category is Improved Liveability.

### Find out how this can be your new home

To apply or to arrange an inspection, contact DFFH on:

[westvct@dffh.vic.gov.au](mailto:westvct@dffh.vic.gov.au)

[www.dffh.vic.gov.au](http://www.dffh.vic.gov.au)

For SIL enquiries or for more details contact Scope on:

1300 472 673

[contact@scopeaust.org.au](mailto:contact@scopeaust.org.au)

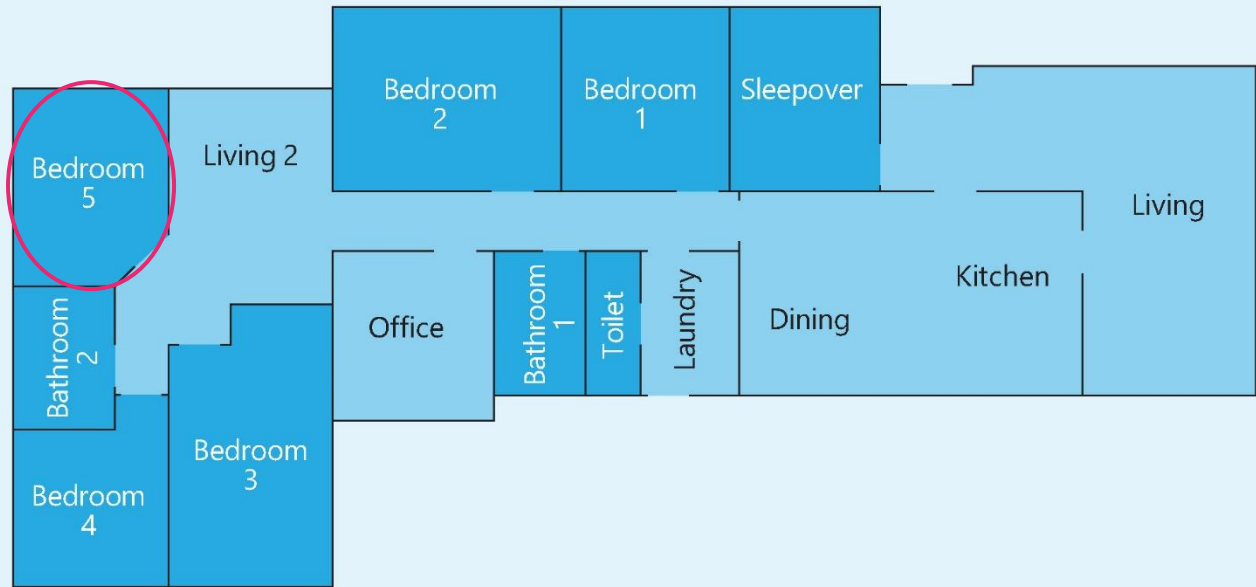

**Making an enquiry**

1300 472 673

[VacancyEnquiries@scopeaust.org.au](mailto:VacancyEnquiries@scopeaust.org.au)