



Supported Independent Living in Croydon

Property ID: 464
Vacancies: 1



Bedrooms:
5



Bathrooms:
2



Property Owner:
Department of Families, Fairness and Housing (DFFH)



NDIS Funded SDA Design Category:
Fully Accessible



Support provided:
Seven days per week with sleep over support model



*Your
new home*

Enjoy living in a fully accessible house, only a short distance from shops, restaurants and cafes.

Features

- Open plan kitchen, dining and living area.
- Large backyard with undercover outdoor seating area and BBQ.
- Two separate living rooms.
- Wheelchair accessible.
- There is a bus located at the house that can be used for transport.
- Property is owned by the Department of Families, Fairness & Housing (DFFH) and staff support is provided by Scope.

Current residents

- One female and three male residents between the ages of 40-65 years old.
- They enjoy horse riding, being outdoors, football, listening to music, and living a relaxed and quiet semi-retired lifestyle.

Bedroom features

- Built in robes.
- Heating and cooling.

Local area

- Only a short walk to Croydon North shopping village, and the local Coles.
- Parks, walking tracks and the Barneong Reserve are nearby.
- Nearest bus stop is within 200m.

- Walking distance to Croydon Family Practice medical centre.
- Croydon station is a ten-minute drive away.

Interested in applying?

Before applying, make sure:

- The applicant is aged 18 years or over.
- The applicant has approved SDA eligibility and NDIA funding at the appropriate level.
- The applicant has the financial means to pay rent and utilities and is prepared to sign (or a representative to sign) a residential agreement.
- Specialist Disability Accommodation (SDA) design category for this house is Fully Accessible.

Find out how this can be your new home

To apply or to arrange an inspection, contact DFFH on:

eastvct@dffh.vic.gov.au
www.dffh.vic.gov.au

For SIL enquiries or for more details contact

Scope on:

1300 472 673

contact@scopeaust.org.au

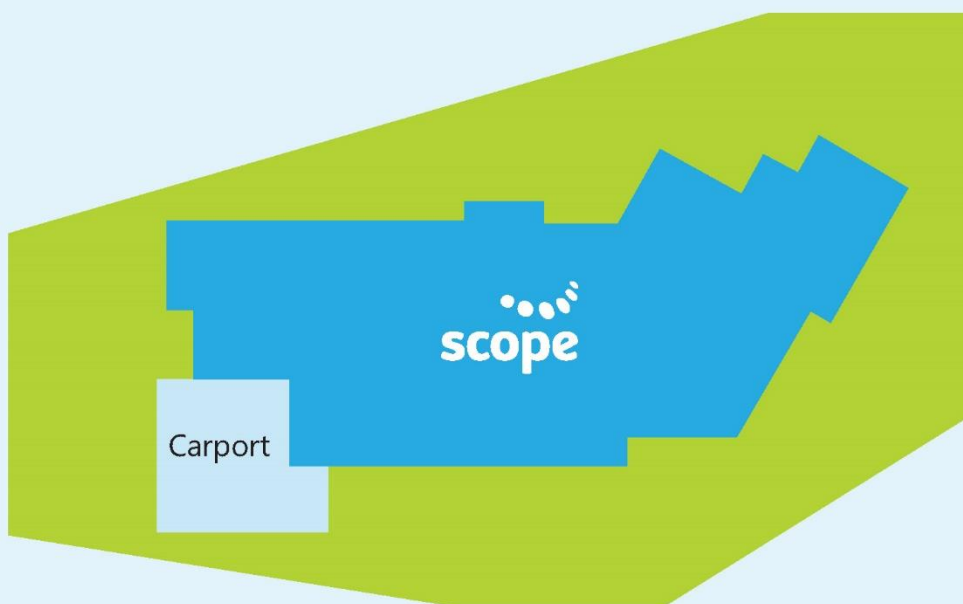
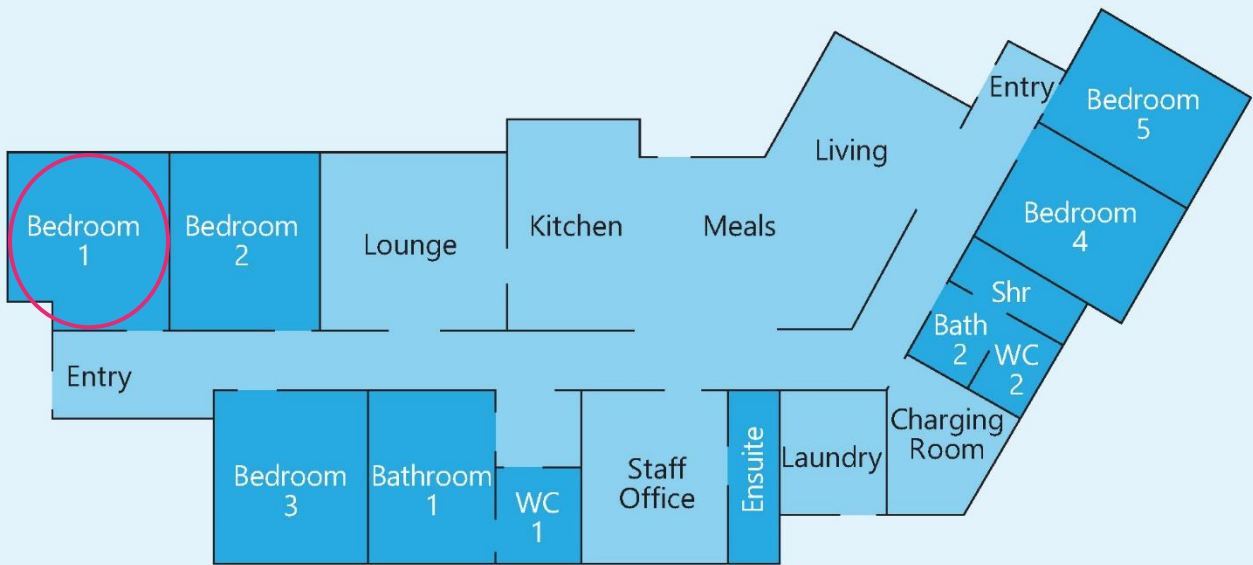

Making an enquiry

1300 472 673

contact@scopeaust.org.au