



Supported Independent Living in Croydon

Property ID: 646



Bedrooms:
6



Bathrooms:
2



Property Owner:
Department of Families, Fairness and Housing (DFFH)



NDIS Funded SDA Design Category:
Robust Construction



Support provided:
Active night model of support



*Your
new home*

A well-presented home amongst the trees with a spacious backyard.

Features

- 6-bedroom house featuring two living areas, spacious kitchen and separate laundry.
- Spacious backyard including play equipment, inground trampoline and a swing.
- This property is owned by DFFH, and staff support is provided by Scope.
- **This house is not wheelchair accessible.**

Current residents

- Two residents who are both males under 21 years old.
- The current residents enjoy music and a mixture of activities inside and outside at home as well as spending time within the community.

Bedroom features

- Built in robes.
- Evaporative cooling and ducted heating.

Nearby facilities

- Small reserve located next to house, and larger parks within walking distance.
- Kilsyth Centenary Pool and Mooroolbark Miniature Railway are a short 5-minute drive away.
- Local shops are also only a 5-minute drive away.

Interested in applying?

Before applying, make sure:

- The applicant is aged 18 years or over.
- The applicant has approved SDA eligibility and NDIA funding at the appropriate level.
- The applicant has the financial means to pay rent and utilities and is prepared to sign (or a representative to sign) a residential agreement.
- Specialist Disability Accommodation (SDA) category for this house is Robust Construction.

Find out how this can be your new home

To apply, or for more details about this vacancy, contact DFFH on:

eastvct@dffh.vic.gov.au

www.dffh.vic.gov.au

To arrange a time to visit, or for more details contact us on:

1300 472 673

VacancyEnquiries@scopeaust.org.au

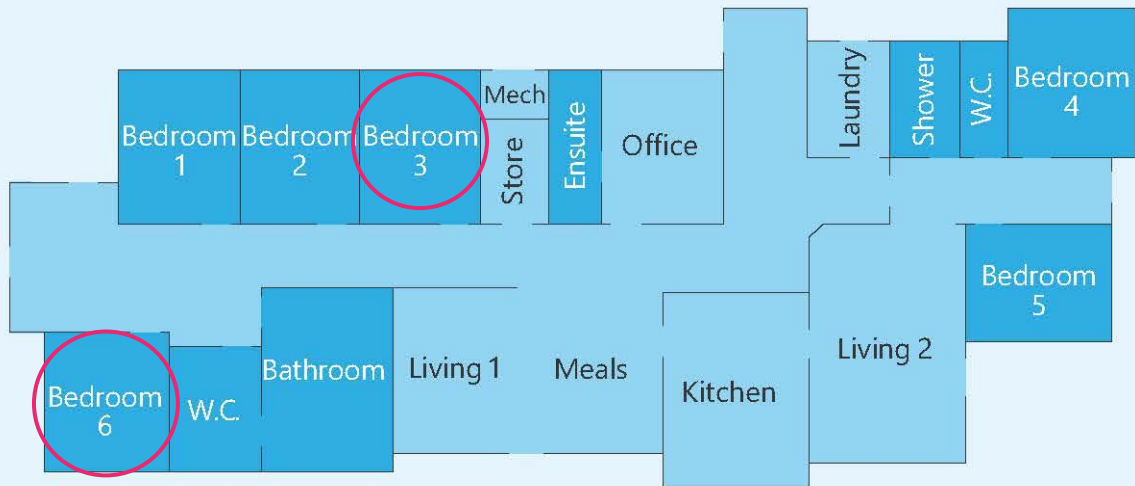
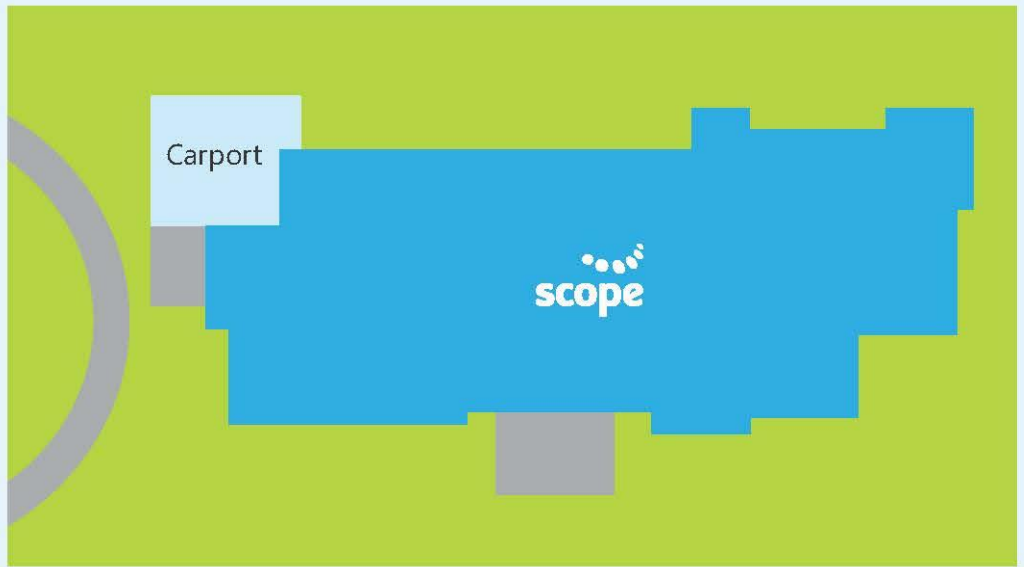

Making an enquiry

1300 472 673

VacancyEnquiries@scopeaust.org.au