



Supported Independent Living in Glenroy

Property ID: 288

Vacancies: 1



Bedrooms:
5



Bathrooms:
2



Property Owner:
Department of Families, Fairness and Housing (DFFH)



NDIS Funded
SDA Design Category:
Fully Accessible



Support provided:
Active Night



*Your
new home*

Open plan house with a spacious backyard in an ideal Glenroy location.

Features

- This property is owned by the Department of Families, Fairness and Housing (DFFH) with staff support provided by Scope.
- Five bedroom house with two bathrooms.
- Generous open plan kitchen and meals area.
- Covered outdoor entertainment area and spacious lawn.
- Wheelchair accessible.

Current residents

- This property currently has four male residents aged between 45-60 years.
- Current residents are social and friendly and participate in a wide range of independent activities.

Bedroom features

- Built-in robes.
- Air conditioning and heating.

Local area

- Local shopping precinct and Glenroy train station within walking distance.
- Recreation opportunities close by include Fawkner Park Reserve and Oak Park Sport and Aquatic Centre.
- Only a short walk from Pascoe Vale market.

- Easy access to Glenroy Neighbourhood Learning Centre.

Interested in applying?

Before applying, make sure:

- The applicant is aged 18 years or over.
- The applicant has approved SDA eligibility and NDIA funding at the appropriate level.
- The applicant has the financial means to pay rent and utilities and is prepared to sign (or a representative to sign) a residential agreement.
- The Specialist Disability Accommodation (SDA) design category for this house is Fully Accessible.
- The SDA building type for this house is Group Home.

Find out how this can be your new home

To apply, or for more details about this vacancy, contact DFFH on:

northvct@dffh.vic.gov.au
www.dffh.vic.gov.au

To arrange a time to visit, or for more details contact us on:

1300 472 673

VacancyEnquiries@scopeaust.org.au



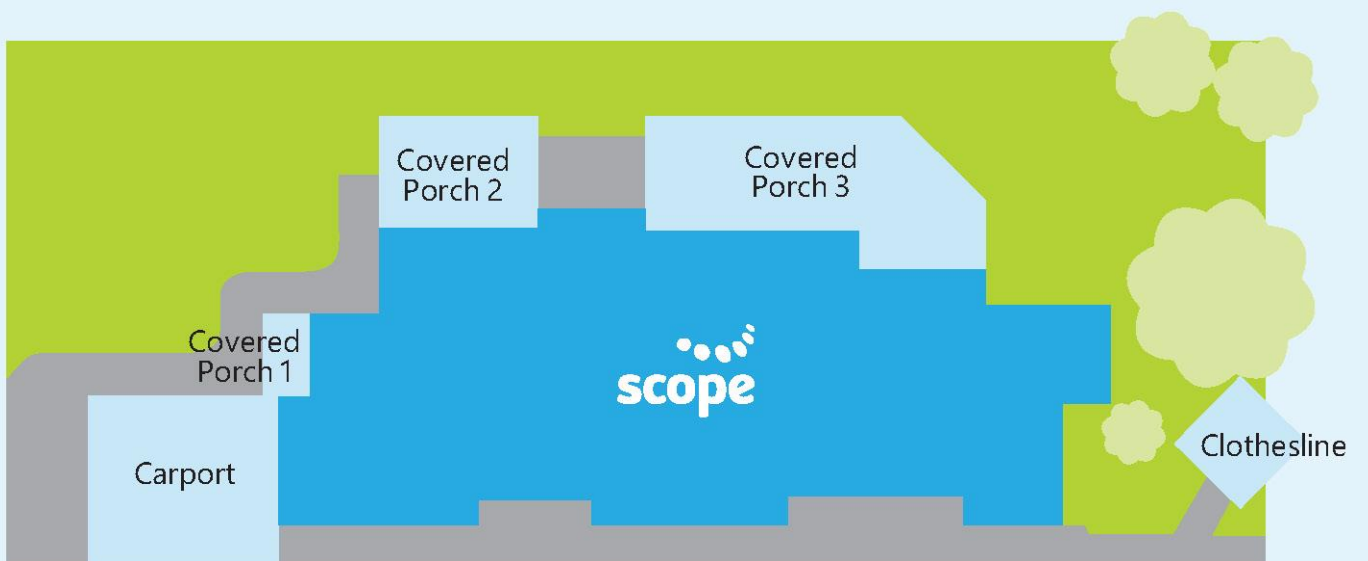
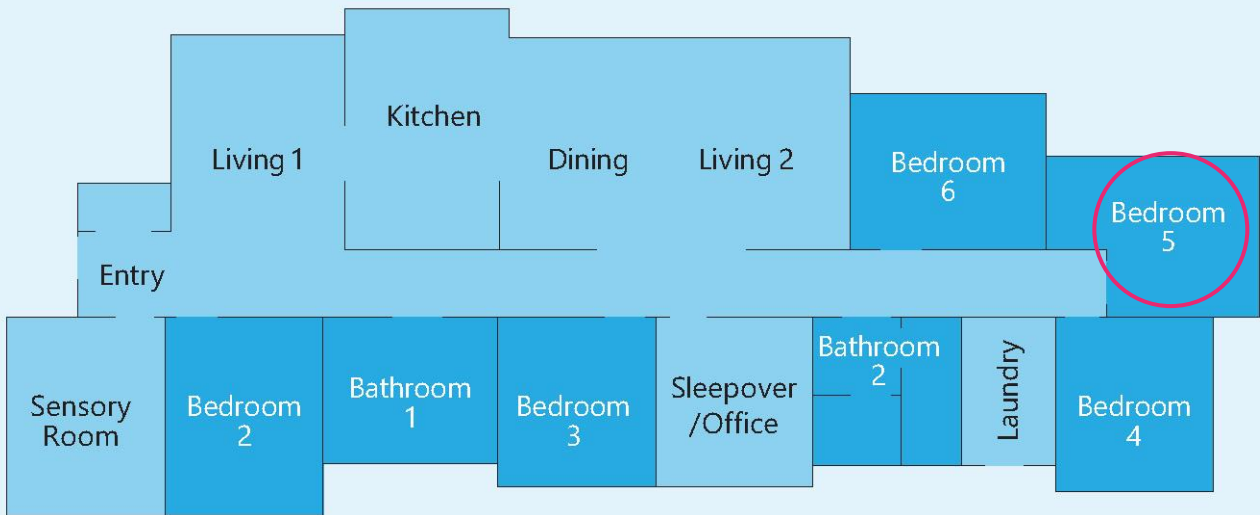

Making an enquiry

1300 472 673

VacancyEnquiries@scopeaust.org.au