



# Supported Independent Living in Hawthorn

Property ID: 471

Vacancies: 1



**Bedrooms:**  
5



**Bathrooms:**  
2



**Property Owner:**  
Department of Families, Fairness and Housing (DFFH)



**NDIS Funded  
SDA Design Category:**  
Fully Accessible



**Support provided:**  
7 days per week  
with active night  
support model



**Your  
new home**

## Enjoy living in an ideal location close to public transport and shops.

### Features

- Ramp entry and a stepless shower.
- Open plan lounge, kitchen and dining area.
- Two separate living rooms to relax in.
- Communal gardens and gazebo outdoor seating area with a BBQ and seating area, perfect for socialising and outdoor entertainment.
- Please note this house is not suitable for people who use a mobility aid.

### Current residents

- This house has both male and female residents, with ages between 50-60 years old.
- The residents enjoy sport, dance, cooking, crafts and socialising.

### Bedroom features

- Built-in robes.
- Heating and cooling.
- Natural light.

### Local area

- Close to train and tram services.
- Easily accessible via the Monash Freeway.
- Close to Glenferrie shopping precinct and Riversdale Junction restaurants and shops.
- Enjoy being active with swimming centres and Fairview Park nearby.

### Interested in applying?

#### Before applying, make sure:

- The applicant is aged 18 years or over.
- The applicant has approved Specialist Disability Accommodation (SDA) eligibility and NDIS funding at the appropriate level.
- The applicant has the financial means to pay rent and utilities and is prepared to sign (or a representative to sign) a residential agreement.
- The SDA building type is Legacy.
- The SDA design category is Fully Accessible.

### Find out how this can be your new home

To apply or to arrange an inspection, contact DFFH on:

[eastvct@dffh.vic.gov.au](mailto:eastvct@dffh.vic.gov.au)  
[www.dffh.vic.gov.au](http://www.dffh.vic.gov.au)

For SIL enquiries or for more details contact

Scope on:

1300 472 673

[contact@scopeaust.org.au](mailto:contact@scopeaust.org.au)



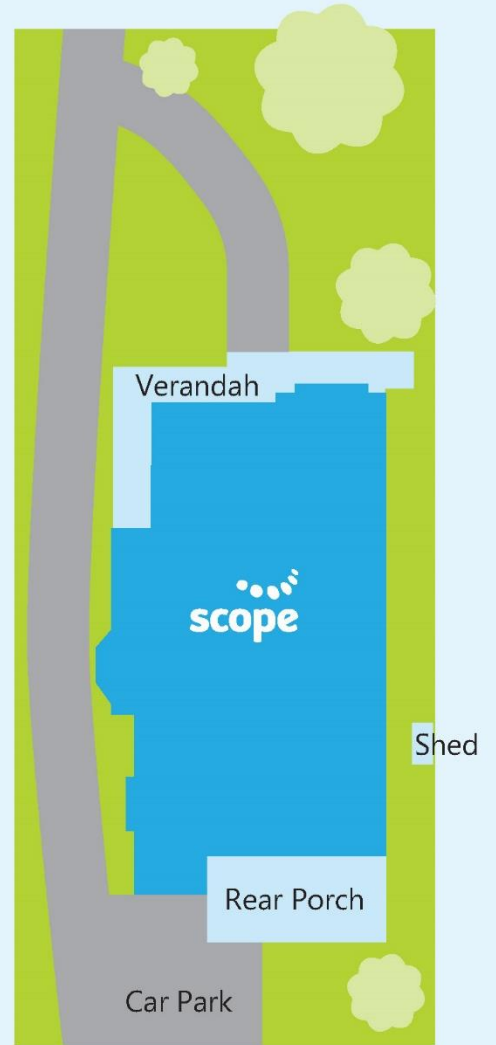
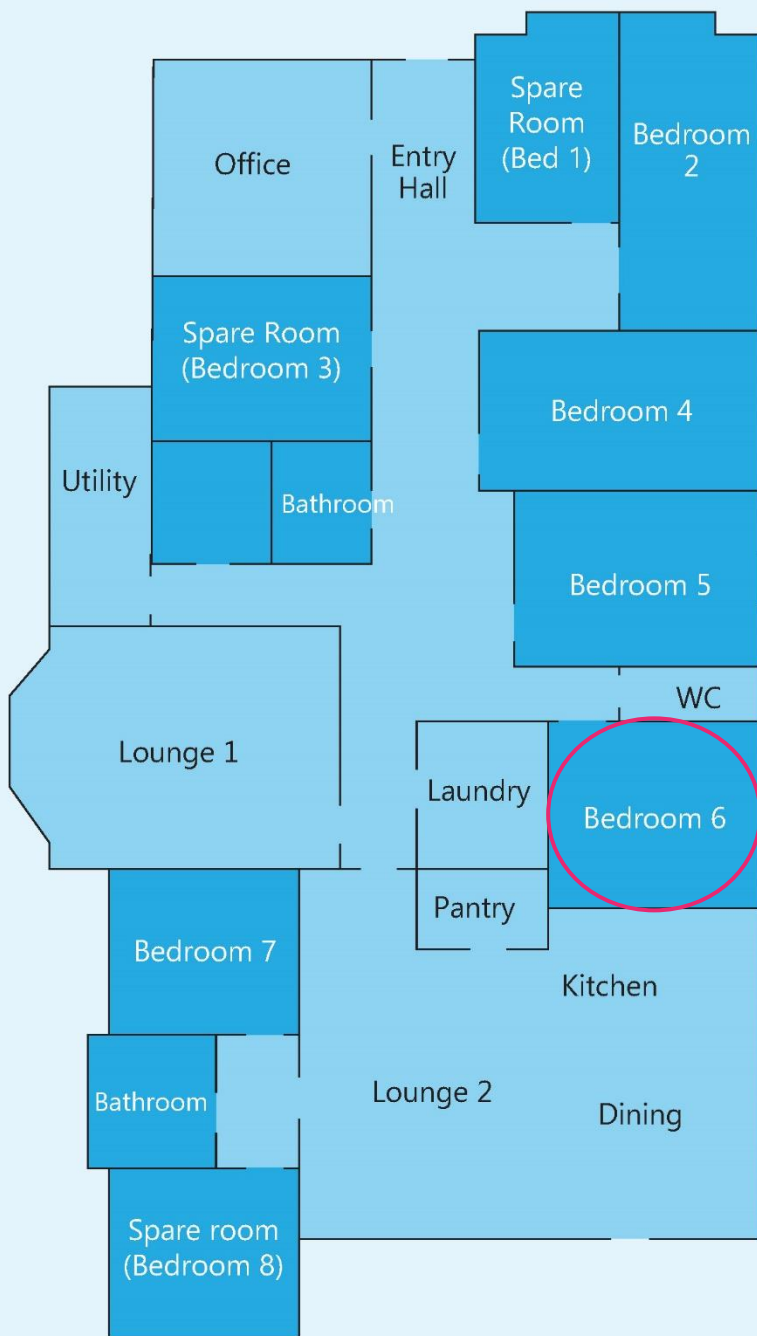

**Making an enquiry**

1300 472 673

[contact@scopeaust.org.au](mailto:contact@scopeaust.org.au)