



Supported Independent Living in Keilor Lodge

Property ID: 174

Vacancies: 1



Bedrooms:
5



Bathrooms:
2



Property Owner:
Department of
Families, Fairness
and Housing (DFFH)



**NDIS Funded
SDA Design Category:**
Basic



Support provided:
Seven days per week
with sleep over
support model



**Your
new home**

Featuring a beautiful backyard with raised garden beds and a BBQ entertainment area.

Features

- This property is owned by DFFH with staff support provided by Scope.
- Two full bathrooms with toilet, plus an additional separate toilet.
- A rumpus room and a separate lounge room.
- Manicured garden has six raised vegetable blocks that is the pride and joy of residents.
- BBQ area with a pergola offering the opportunity to gather family and friends.
- On Monday to Friday, support is provided during peak times in the morning and afternoon with sleepover, and on weekends and public holidays support staff are rostered for the full day.
- *Please Note: This property has a narrow hallways and is not suitable for people who require mobility aides.*

Current residents

- The current residents are aged between 60-70 and are all male.
- They enjoy varied leisure activities such as bowling, music theatres, going to the pub to see shows and short holiday trips on weekends.

Bedroom features

- Built-in robes.
- Carpeted bedroom.
- Heating and cooling for year-round comfort.

Local area

- The property runs off a main road which is serviced by a local bus.
- Close by to Keilor Central Shopping Centre which offers a variety of specialty stores, dining, fashion, medical services, a post office and a Coles supermarket.

Interested in applying?

Before applying, make sure:

- The applicant is aged 18 years or over.
- The applicant has approved SDA eligibility and NDIA funding at the appropriate level.
- The applicant has the financial means to pay rent and utilities and is prepared to sign (or a representative to sign) a residential agreement.
- The Specialist Disability Accommodation (SDA) design category for this house is Basic.
- The SDA building type is Group Home.

Find out how this can be your new home

To apply, or for more details about this vacancy, contact DFFH on:
westvct@dffh.vic.gov.au
www.dffh.vic.gov.au

To arrange a time to visit, or for more details contact us on:
1300 472 673
VacancyEnquiries@scopeaust.org.au

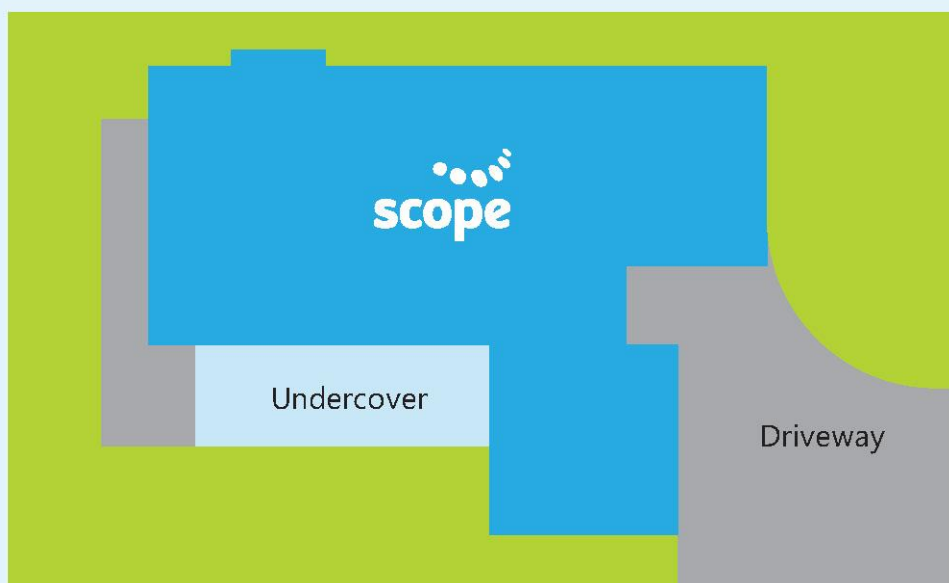
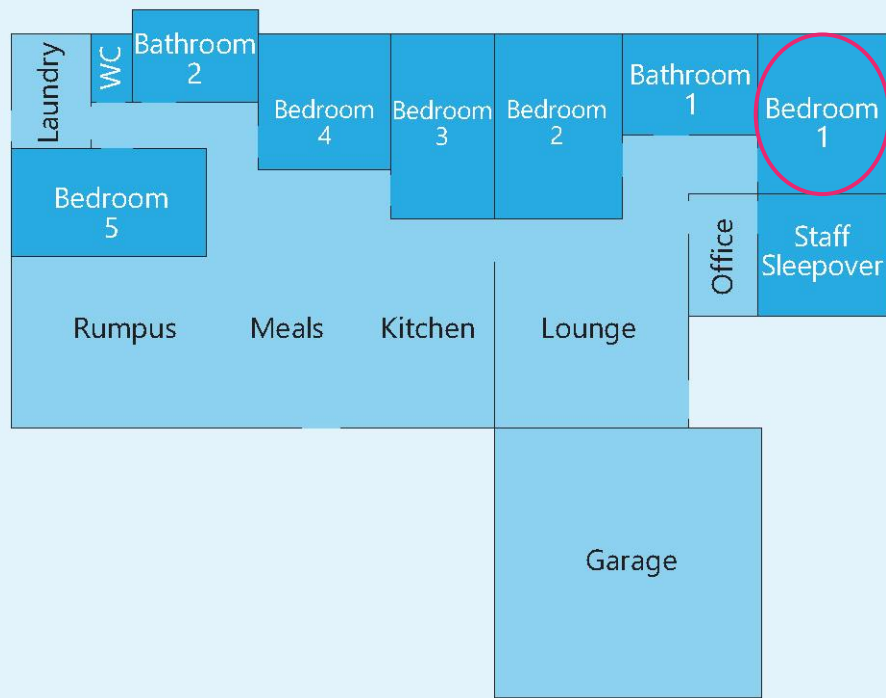

Making an enquiry

1300 472 673

VacancyEnquiries@scopeaust.org.au