



# Supported Independent Living in Kew

Property ID: 680

Vacancies: 1



**Bedrooms:**  
5



**Bathrooms:**  
1 bathroom  
1 shower room  
2 additional  
toilets



**Property Owner:**  
Department of  
Families, Fairness  
and Housing (DFFH)



**NDIS Funded  
SDA Design Category:**  
Robust Construction



**Support provided:**  
Seven days per week  
with active night



*Your  
new home*

## Quiet home with easy access to public transport in a lovely, leafy suburb.

### Features

- Open plan kitchen, dining and living area.
- Undercover outdoor seating area perfect for relaxing or entertaining.
- Two separate living rooms.
- Wheelchair accessible.
- Property is owned by the Department of Families, Fairness & Housing (DFFH) and staff support is provided by Scope.

### Current residents

- There are three male residents and one female resident, between the ages of 35-70.
- All the residents have a strong bond, and they enjoy spending time with family, helping with the household chores, attending supports during the week, bus outings, and going to restaurants.
- The ideal new housemate will be someone who respects others' boundaries and is a quiet, peaceful person.

### Bedroom features

- Built-in robes.
- Heating and cooling.

### Local area

- Local shopping hub, including a supermarket and cafes only 1km from home.
- Easy access to public transport with trams and buses within walking distance.

- Plenty of recreation opportunities close by including Yarra Bend Park and Victoria Gardens Shopping Centre.

### Interested in applying?

#### Before applying, make sure:

- The applicant is aged 18 years or over.
- The applicant has approved SDA eligibility and NDIA funding at the appropriate level.
- The applicant has the financial means to pay rent and utilities and is prepared to sign (or a representative to sign) a residential agreement.
- The Specialist Disability Accommodation (SDA) design category is Robust Construction.

### Find out how this can be your new home

To apply or to arrange an inspection, contact DFFH on:

[eastvct@dffh.vic.gov.au](mailto:eastvct@dffh.vic.gov.au)  
[www.dffh.vic.gov.au](http://www.dffh.vic.gov.au)

For SIL enquiries or for more details contact

Scope on:

1300 472 673

[contact@scopeaust.org.au](mailto:contact@scopeaust.org.au)



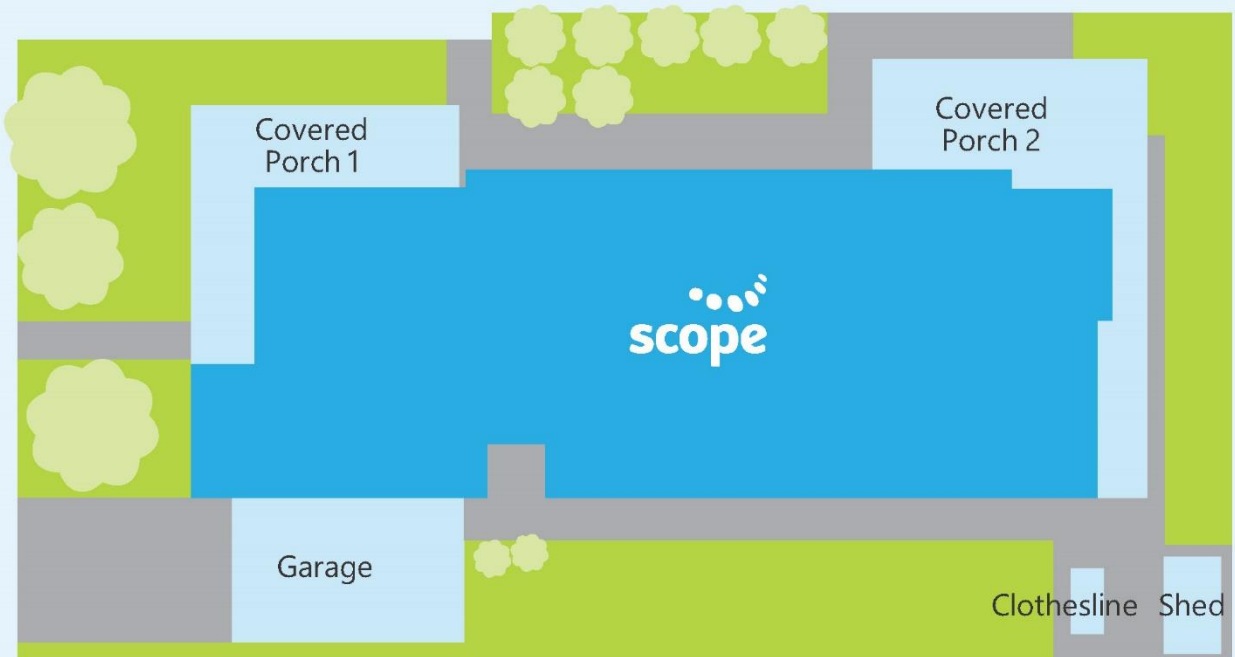
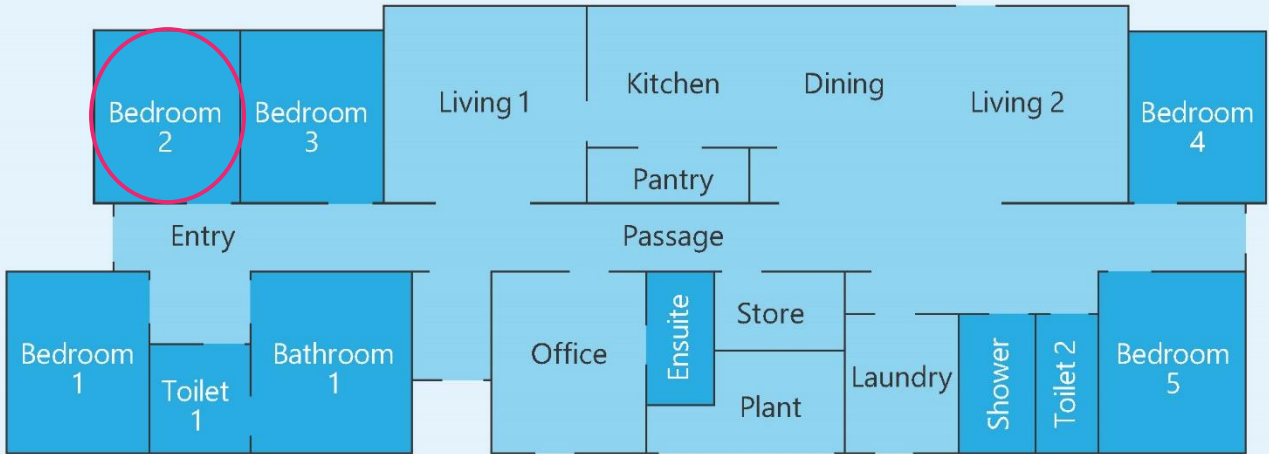

**Making an enquiry**

1300 472 673

[VacancyEnquiries@scopeaust.org.au](mailto:VacancyEnquiries@scopeaust.org.au)