



# Supported Independent Living in Kew

Property ID: 696

Vacancies: 1



**Bedrooms:**  
5



**Bathrooms:**  
2



**Property Owner:**  
Department of Families, Fairness and Housing (DFFH)



**NDIS Funded  
SDA Design Category:**  
Fully Accessible



**Support provided:**  
Seven days per week  
with active night support



*Your  
new home*

## A fully accessible home with a lovely outdoor area, close to shops and cafes.

### Features

- Wide corridors and open plan design for ease of movement.
- Wheelchair accessible with stepless entries.
- Two spacious living rooms to relax in.
- The backyard has a seating area and veggie gardens for outdoor enjoyment and entertaining.
- Two adorable pet cats named Pavlova and Becka.
- Experienced team of staff trained in epilepsy management, behaviour support, manual handling and mealtime assistance.
- This house is suitable for people with high support needs (including mobility support).

### Current residents

- Two male and two female residents with ages between 45-65 years old.
- They enjoy relaxing in a quiet home environment, seeing family, attending day programs and watching football.
- A friendly person who can respect others' personal space while enjoying the company of others would be ideal for this house.

### Bedroom features

- Built-in robes.
- Air conditioning and heating.
- Ceiling hoist.

### Local area

- Conveniently close to tram services, bus stops, shops, parks and cafes.
- Easily accessible via the Eastern Freeway.

### Interested in applying?

#### Before applying, make sure:

- The applicant is aged 18 years or over.
- The applicant has approved SDA eligibility and NDIA funding at the appropriate level.
- The applicant has the financial means to pay rent and utilities and is prepared to sign (or a representative to sign) a residential agreement.
- The Specialist Disability Accommodation (SDA) design category is Fully Accessible.
- The SDA building type is Group Home.

### Find out how this can be your new home

To apply or to arrange an inspection, contact DFFH on:

[eastvct@dffh.vic.gov.au](mailto:eastvct@dffh.vic.gov.au)

[www.dffh.vic.gov.au](http://www.dffh.vic.gov.au)

For SIL enquiries or for more details contact

Scope on:

1300 472 673

[contact@scopeaust.org.au](mailto:contact@scopeaust.org.au)

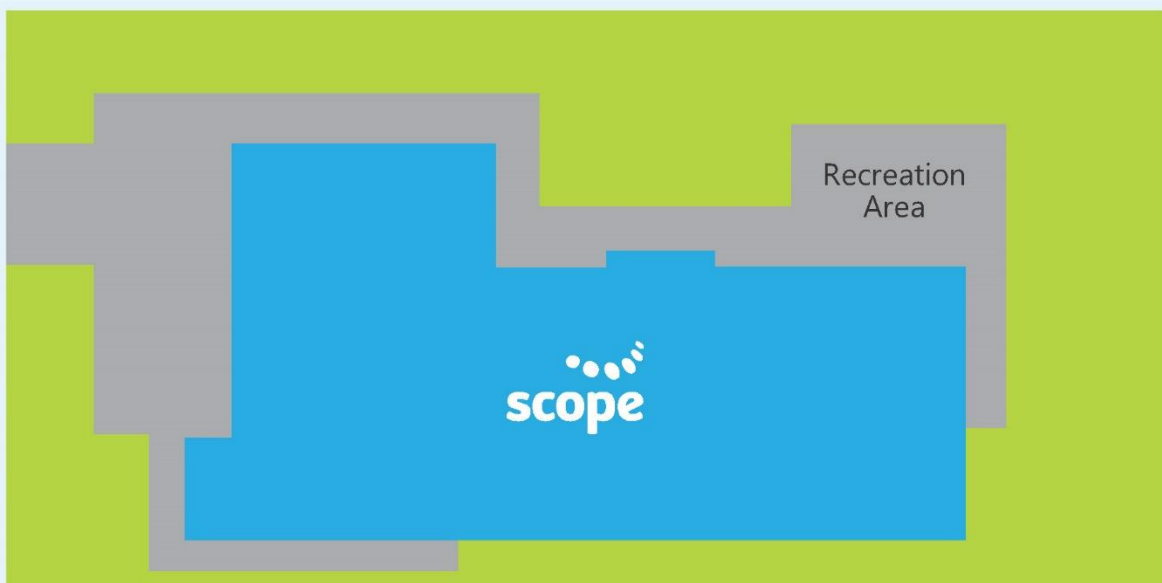
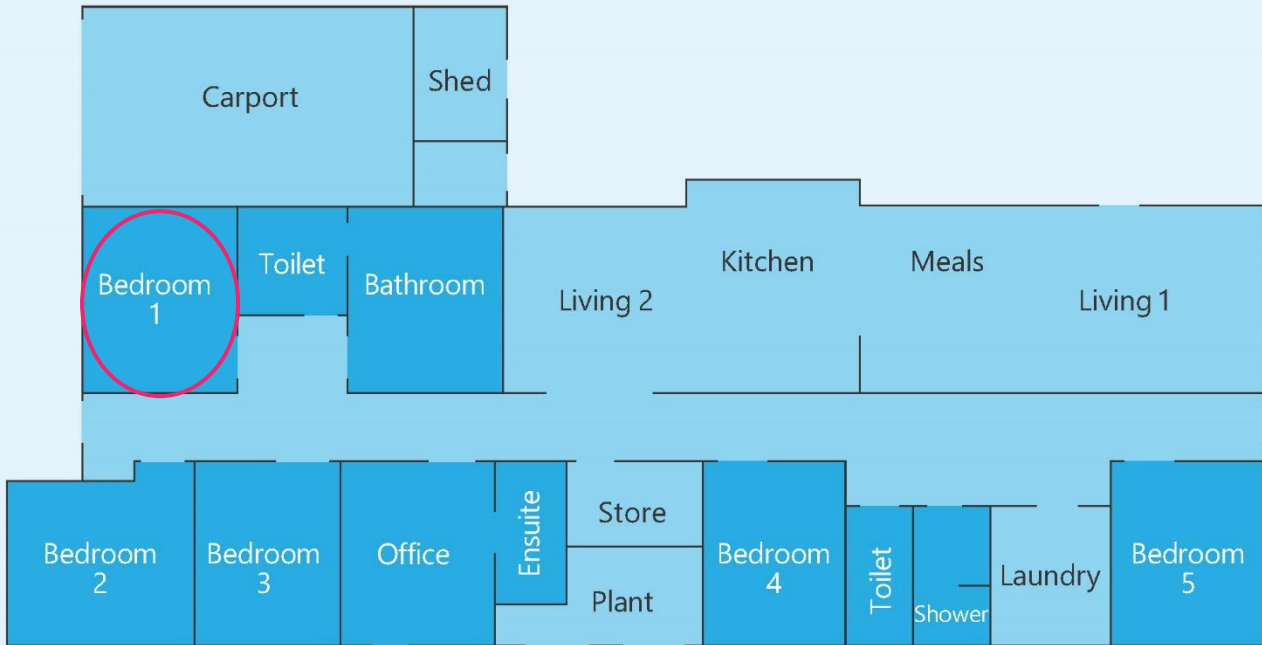

## **Making an enquiry**

1300 472 673

[contact@scopeaust.org.au](mailto:contact@scopeaust.org.au)