



Supported Independent Living in Mooroolbark

Property ID: 663



Bedrooms:
5



Bathrooms:
2



Property Owner:
Department of Families, Fairness and Housing (DFFH)



**NDIS Funded
SDA Design Category:**
Fully Accessible



Support provided:
Seven days per week
with sleepover
support model



*Your
new home*

Open plan living in Mooroolbark with a spacious mature garden and outdoor entertaining.

Features

- Purpose built property with two living areas.
- Open plan kitchen with dishwasher, oven, breakfast bench and gas stove.
- Spacious rear yard with fruit trees, vegetable patch, outdoor seating area and a shed.
- House is suitable for people who require support to undertake daily living activities.
- Two bathrooms with separate toilets and separate showers.
- Ten-seater Toyota bus.

Current residents

- Males aged between 40-56 years.

Bedroom features

- Evaporative cooling and heating.
- South-facing window.
- Built-in robe.
- TV fixed to the wall.

Nearby amenities

- Walking track.
- Bus stop, Lilydale and Mooroolbark train stations nearby.
- Close to Chirnside Park Shopping Centre, Cafes, Lilydale Lake.

Interested in applying?

Before applying, make sure:

- The applicant is aged 18 years or over.
- The applicant has approved SDA eligibility and NDIA funding at the appropriate level.
- The applicant has the financial means to pay rent and utilities and is prepared to sign (or a representative to sign) a residential agreement.
- Specialist Disability Accommodation (SDA) category for this house is Fully Accessible.

Find out how this can be your new home

To apply, or for more details about this vacancy, contact DFFH on:

eastvct@dffh.vic.gov.au

www.dffh.vic.gov.au

For SIL enquiries, contact Scope on:
1300 472 673

VacancyEnquiries@scopeaust.org.au

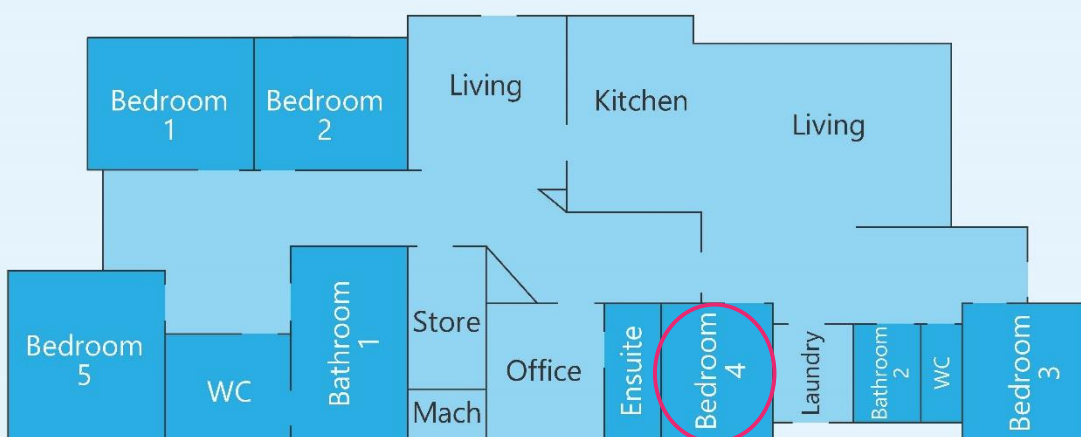
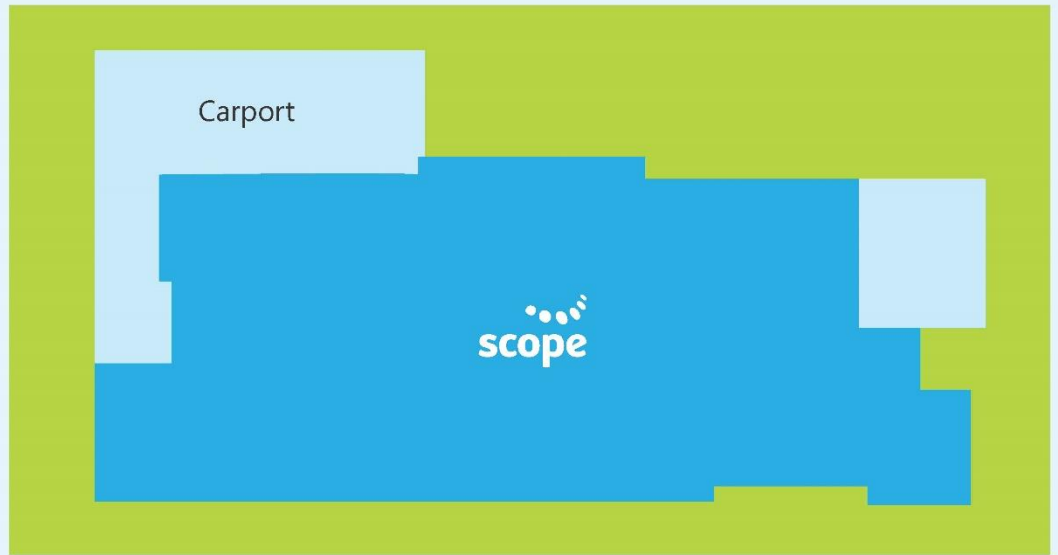

Making an enquiry

1300 472 673

VacancyEnquiries@scopeaust.org.au