



Supported Independent Living in Mount Evelyn

Property ID: 563

Vacancies: 1



Bedrooms:
2



Bathrooms:
2



Property Owner:
Department of Families, Fairness and Housing (DFFH)



**NDIS Funded
SDA Design Category:**
Fully Accessible



Support provided:
Seven days per week
with sleep over
support model



*Your
new home*

Enjoy living in this two-bedroom unit in Melbourne's East.

Features

- This two-bedroom unit has a kitchen, dining area, living room, two bathrooms and a laundry.
- Undercover outdoor seating area to relax in.
- Wheelchair accessible.
- Property is owned by the Department of Families, Fairness & Housing (DFFH) and staff support is provided by Scope.

Current residents

- One male resident in their 30s, who enjoys attending day programs, listening to the radio and going for drives in the community.

Bedroom features

- Built-in robes.
- Heating and cooling.

Local area

- Very close to local shops, restaurants and cafes.
- Nearest bus stop is only 150m away.
- Five-minute drive to Lilydale lake.
- Close to parks, gardens and walking tracks, including the Warburton walking trail.

Interested in applying?

Before applying, make sure:

- The applicant is aged 18 years or over.
- The applicant has approved SDA eligibility and NDIA funding at the appropriate level.
- The applicant has the financial means to pay rent and utilities and is prepared to sign (or a representative to sign) a residential agreement.
- The Specialist Disability Accommodation (SDA) design category is Fully Accessible.

Find out how this can be your new home

To apply or to arrange an inspection, contact DFFH on:
eastvct@dffh.vic.gov.au
www.dffh.vic.gov.au

For SIL enquiries or for more details contact Scope on:
1300 472 673
contact@scopeaust.org.au



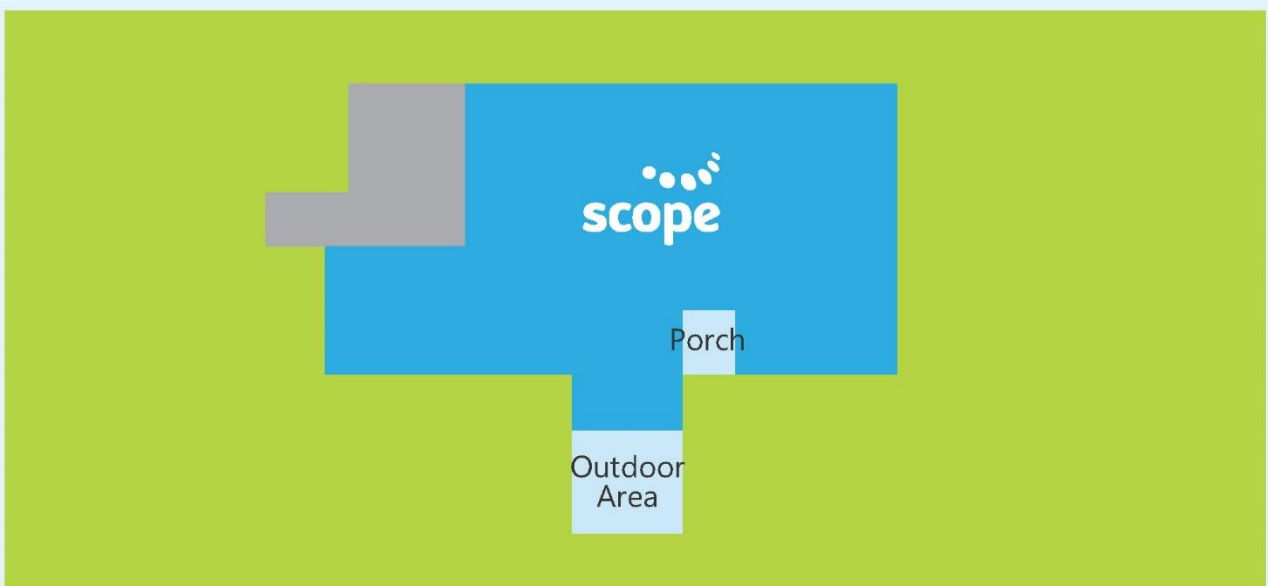
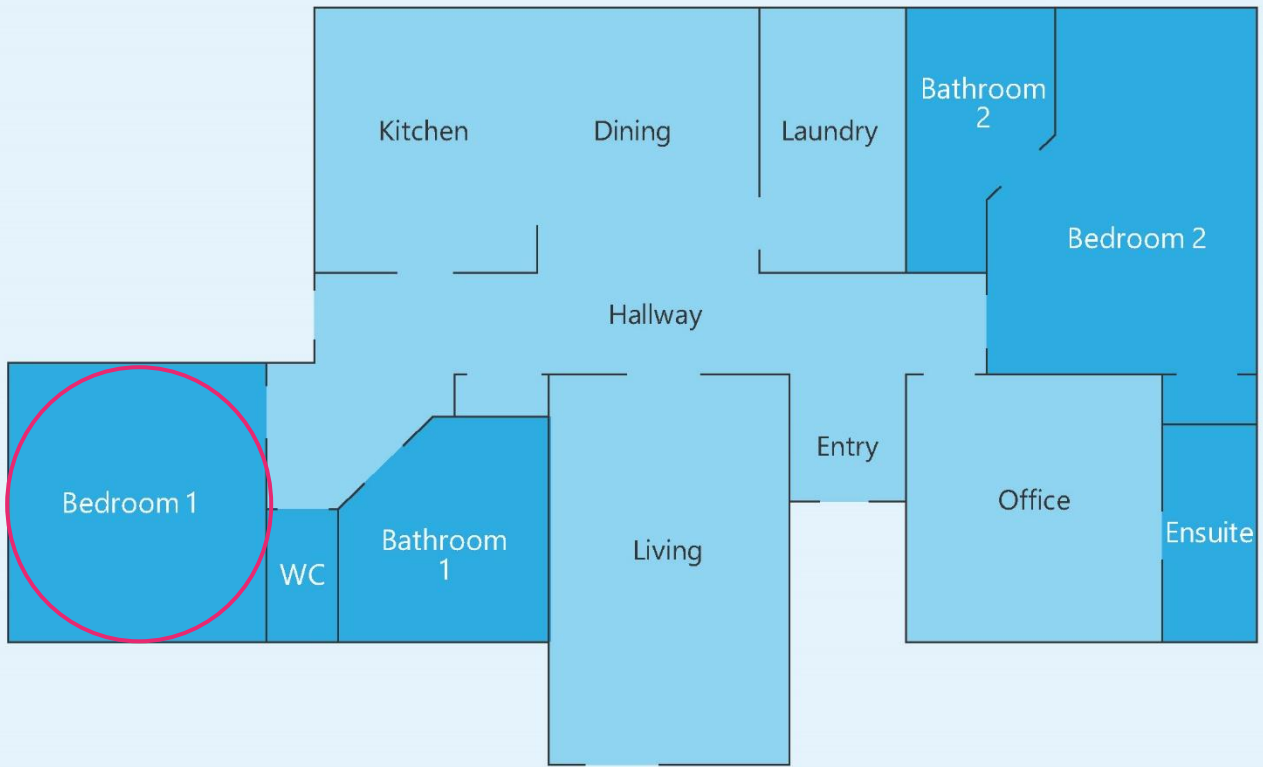

Making an enquiry

1300 472 673

contact@scopeaust.org.au