



# Supported Independent Living in Newcomb

Property ID: 594

Vacancies: 1



**Bedrooms:**  
5



**Bathrooms:**  
1 bathroom  
1 shower room  
2 toilets



**Property Owner:**  
Department of  
Families, Fairness  
and Housing (DFFH)



**NDIS Funded  
SDA Design Category:**  
Improved Liveability



**Support provided:**  
Seven days per week  
with sleep over  
support model



**Your  
new home**

## Enjoy a spacious backyard and living close to the Geelong Waterfront.

### Features

- Open plan kitchen, dining and living area.
- Two separate living rooms.
- One full bathroom, one shower room and two additional toilets.
- Spacious, well-maintained backyard.
- Undercover outdoor seating area perfect for relaxing or entertaining.
- Broadband internet access available.
- Wheelchair accessible.
- Property is owned by DFFH and staff support is provided by Scope.

### Current residents

- The current residents are aged between 50-65 years and are all female.
- Residents attend supports during the day and enjoy dining out, shopping, helping around the house and spending time outside.
- Someone who is female with a calm personality, who enjoys chatting and going for walks would be ideal for this household.

### Bedroom features

- Built-in robes.
- Heating and cooling.
- Ceiling hoist.

### Local area

- Bellarine Village Shopping Centre is less than 2km from the home.

- Easy access to public transport with the closest bus stop a short two-minute walk away.
- Geelong town centre is less than 15 minutes away by car
- Close to restaurants and pubs.
- Only a six-minute drive from Geelong Waterfront.

### Interested in applying?

#### Before applying, make sure:

- The applicant is aged 18 years or over.
- The applicant has approved SDA eligibility and NDIA funding at the appropriate level.
- The applicant has the financial means to pay rent and utilities and is prepared to sign (or a representative to sign) a residential agreement.
- The Specialist Disability Accommodation (SDA) design category is Improved Liveability.
- The SDA building type is Group Home.

### Find out how this can be your new home

To apply or to arrange an inspection, contact DFFH on:

[westvct@dffh.vic.gov.au](mailto:westvct@dffh.vic.gov.au)  
[www.dffh.vic.gov.au](http://www.dffh.vic.gov.au)

For SIL enquiries or for more details contact Scope on:

1300 472 673  
[contact@scopeaust.org.au](mailto:contact@scopeaust.org.au)

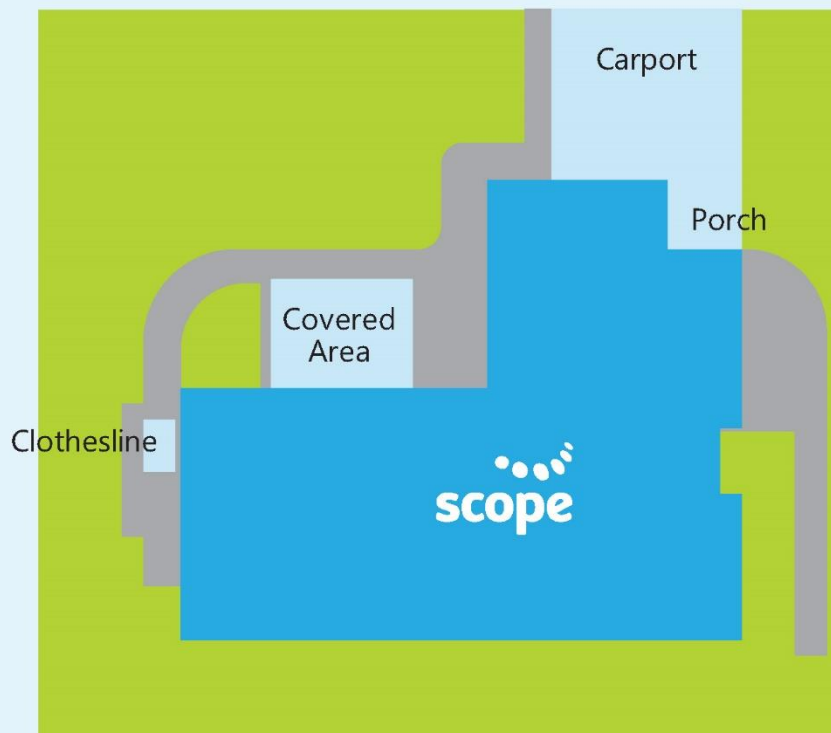
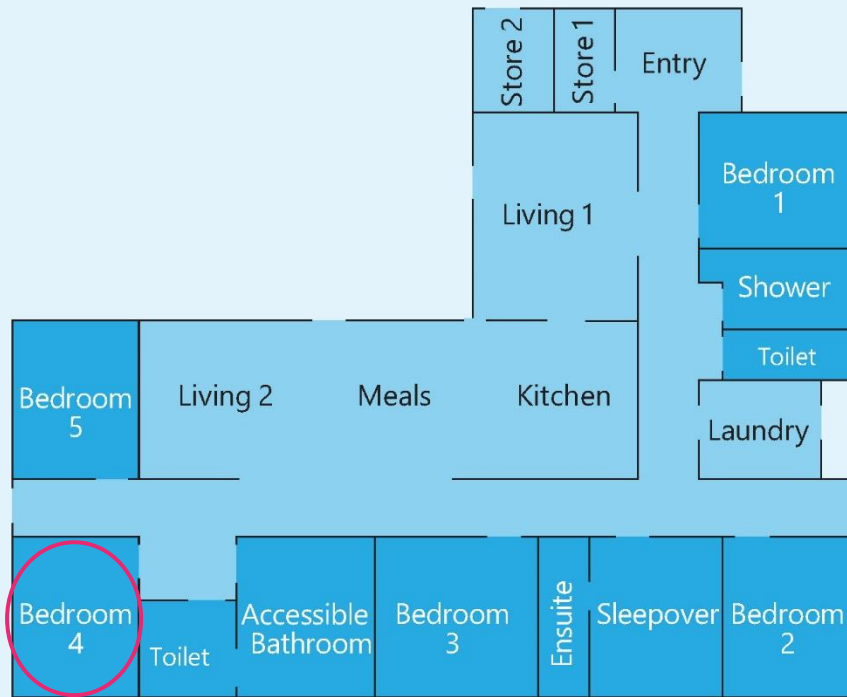

**Making an enquiry**

1300 472 673

[VacancyEnquiries@scopeaust.org.au](mailto:VacancyEnquiries@scopeaust.org.au)