



Supported Independent Living in Ormond

Property ID: 266

Vacancies: 1



Bedrooms:
5



Bathrooms:
2



Property Owner:
Department of
Families, Fairness
and Housing



**NDIS Funded
SDA Design Category:**
Fully Accessible



Support provided:
Seven days per week
with sleep over
support model



*Your
new home*

Wheelchair accessible home, conveniently close to the train and local shops.

Features

- Wheelchair accessible home with a stepless front and rear entry including automatic front door opening.
- Open plan living featuring a living, dining and kitchen area.
- Two bathrooms, one fully accessible with stepless shower, vanity, toilet, and ceiling hoist.
- Large outdoor area established with trees.
- House is suitable for people who require support to undertake the activities of daily living.
- This property is owned by DFFH with Staff support provided by Scope.

Current residents

- Three male residents aged between 30-55 years old.
- The current residents enjoy spending time in the community and love barracking for their favourite football teams.

Bedroom features

- Built in robes.
- Air conditioning and heating.
- Ceiling hoist.

Local area

- Only 500m from Ormond train station and buses.
- Walking distance to local shops and restaurants
- A short drive to the beautiful Brighton Beach

Interested in applying?

Before applying, make sure:

- The applicant has approved SDA eligibility and NDIA funding at the appropriate level.
- The applicant has the financial means to pay rent and utilities and is prepared to sign (or a representative to sign) a residential agreement.
- Specialist Disability Accommodation (SDA) category for this house is Fully Accessible.

Find out how this can be your new home

To apply or to arrange an inspection, contact DFFH on:

southvct@dffh.vic.gov.au

www.dffh.vic.gov.au

For SIL enquiries, contact Scope on:

1300 472 673

contact@scopeaust.org.au

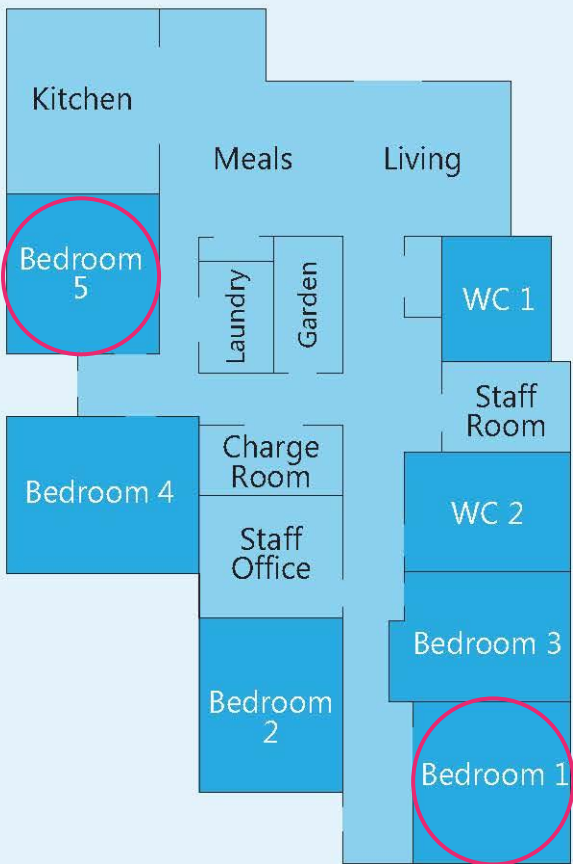

Making an enquiry

1300 472 673

VacancyEnquiries@scopeaust.org.au