



Supported Independent Living in Rowville

Property ID: 170



Bedrooms:
5



Bathrooms:
1



Property Owner:
DFFH



**NDIS Funded
SDA Design Category:**
Basic



Support provided:
7 days per week
with a sleepover
support model



*Your
new home*

Established house with a spacious garden that is close to the local library and shops in the heart of Rowville.

Features

- Connected kitchen, dining, and family areas.
- One bathroom with a separate toilet.
- Large backyard with a generous alfresco area.
- This property is owned by DFFH with staff support provided by Scope.

Current residents

- A mix of male and female residents aged between 25 and 57 years.
- The current residents enjoy a relaxed home environment.

Bedroom features

- Double wardrobes.
- Heating and cooling.
- Privacy blinds.

Nearby facilities

- Close to Stud Park Shopping Centre.
- Short walk to local bus stop.
- Walking tracks and parklands are nearby, including a lakeside reserve.
- Sporting facilities are also close to this house.

Interested in applying?

Before applying, make sure:

- The applicant is aged 18 years or over.
- The applicant has approved SDA eligibility and NDIA funding at the appropriate level.
- The applicant has the financial means to pay rent and utilities and is prepared to sign (or a representative to sign) a residential agreement.
- Specialist Disability Accommodation (SDA) category for this house is Basic.

Find out how this can be your new home

To apply, or for more details about this vacancy, contact DFFH on:

eastvct@dffh.vic.gov.au

www.dffh.vic.gov.au

To arrange a time to visit, or for more details contact us on:

1300 472 673

VacancyEnquiries@scopeaust.org.au

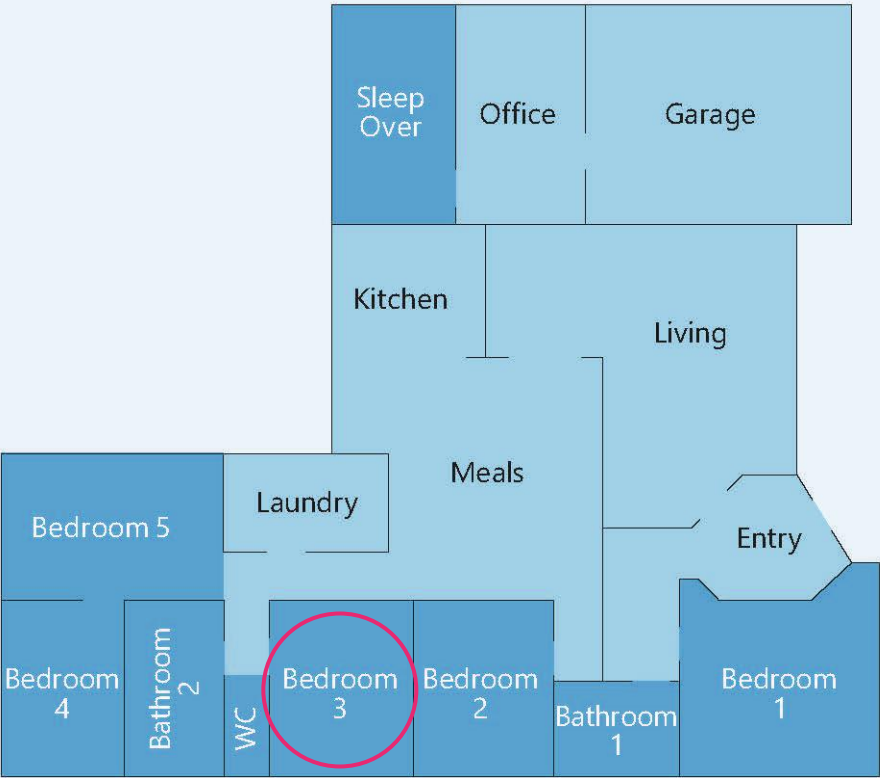

Making an enquiry

1300 472 673

VacancyEnquiries@scopeaust.org.au