



Supported Independent Living in Saint Albans Park

Property ID: 653

Vacancies: 1



Bedrooms:
5



Bathrooms:
2



Property Owner:
Department of Families, Fairness and Housing (DFFH)



NDIS Funded
SDA Design Category:
High Physical Support



Support provided:
Seven days per week
with sleep over
support model



*Your
new home*

Close to Geelong Waterfront, with a spacious backyard and two outdoor seating areas.

Features

- Open plan dining and living area.
- Fantastic backyard with two seating areas, a basketball ring and trampoline.
- Two separate living rooms to relax in.
- Wheelchair accessible.
- Property is owned by the Department of Families, Fairness & Housing (DFFH) and staff support is provided by Scope.

Current residents

- Three male residents and one female resident.
- The residents are aged between 35-70 years old.

Bedroom features

- Built-in robes.
- Heating and cooling.
- Ceiling hoist.

Local area

- Only a short drive to shops, restaurants and Geelong Waterfront.
- Several parks and reserves nearby.
- Bus stops are close to the house.

Interested in applying?

Before applying, make sure:

- The applicant is aged 18 years or over.
- The applicant has approved SDA eligibility and NDIA funding at the appropriate level.
- The applicant has the financial means to pay rent and utilities and is prepared to sign (or a representative to sign) a residential agreement.
- The Specialist Disability Accommodation (SDA) design category is High Physical Support.

Find out how this can be your new home

To apply or to arrange an inspection, contact DFFH on:

westvct@dffh.vic.gov.au
www.dffh.vic.gov.au

For SIL enquiries or for more details contact Scope on:

1300 472 673
contact@scopeaust.org.au

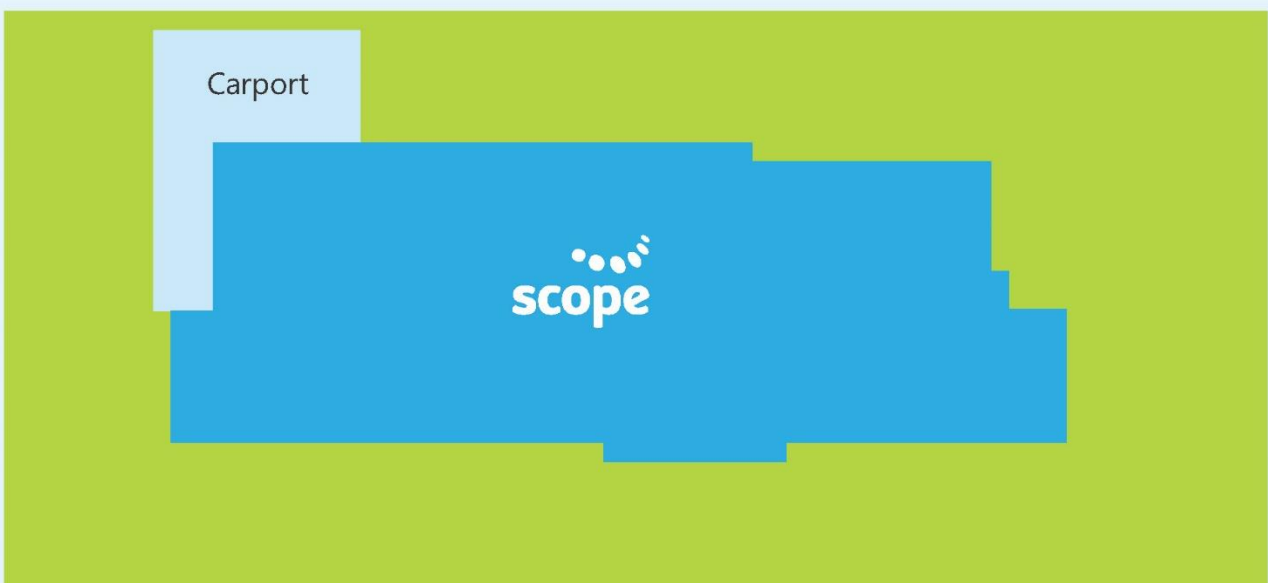
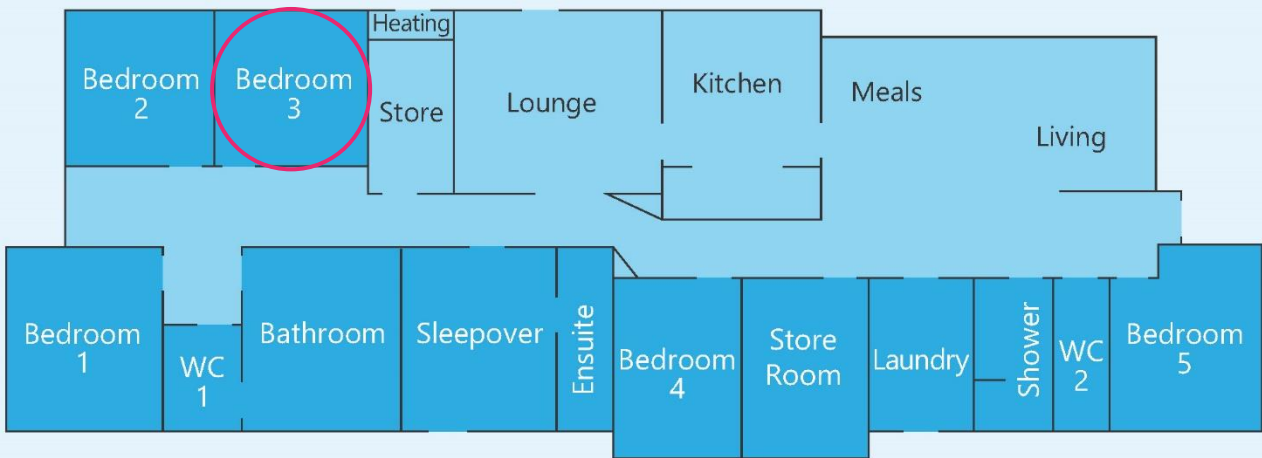

Making an enquiry

1300 472 673

VacancyEnquiries@scopeaust.org.au