



# Supported Independent Living in Wangaratta

Property ID: 701

Vacancies: 2



**Bedrooms:**  
5



**Bathrooms:**  
2



**Property Owner:**  
Department of Families, Fairness and Housing (DFFH)



**NDIS Funded SDA Design Category:**  
High Physical Support



**Support provided:**  
7 days per week with a sleepover support model



*Your  
new home*

## Enjoy living in this spacious, accessible home close to the city centre.

### Features

- This purpose built property is owned by the Department of Families, Fairness and Housing (DFFH) and staff support is provided by Scope.
- Two bathrooms featuring an accessible shower and bath.
- Two living spaces, including a sensory room.
- A large kitchen with a dining room, plus an additional kitchenette and dining area.
- Covered outdoor sitting area.
- House is suitable for people who require high physical support.

### Current residents

- Three female residents aged between 20-60 years.
- Most residents attend supports during the day and enjoy a quiet, relaxing, and settled home environment.
- They participate in their chosen individual and group activities as well as participate in the decision making in the running of their home.

### Bedroom features

- Built in robes.
- Evaporative cooling air and heating.
- Ceiling tracks in both rooms.
- Carpet in Bedroom 4 and vinyl flooring in Bedroom 5.

### Local area

- The house is located in the West End of Wangaratta.
- A five-minute drive to the centre of the town and all amenities.
- A short five-minute drive to the Wangaratta Hospital.

### Interested in applying?

#### Before applying, make sure:

- The applicant is aged 18 years or over.
- The applicant has an appropriate level of NDIS funding.
- The applicant has the financial means to pay rent and utilities and is prepared to sign (or a representative to sign) a residential agreement.
- Specialist Disability Accommodation (SDA) category for this house is High physical support.

### Find out how this can be your new home

To apply, or for more details about this vacancy, contact DFFH on:

eastvct@dffh.vic.gov.au  
www.dffh.vic.gov.au

For SIL enquiries, contact Scope on:  
1300 472 673

VacancyEnquiries@scopeaust.org.au

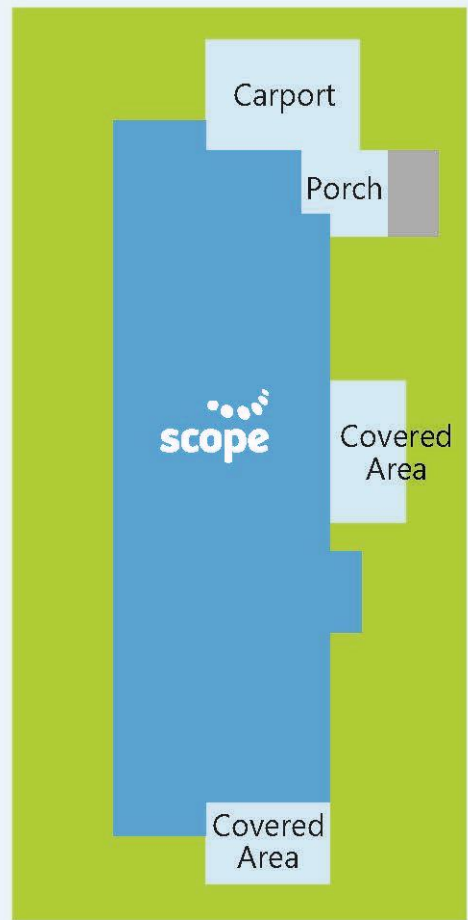
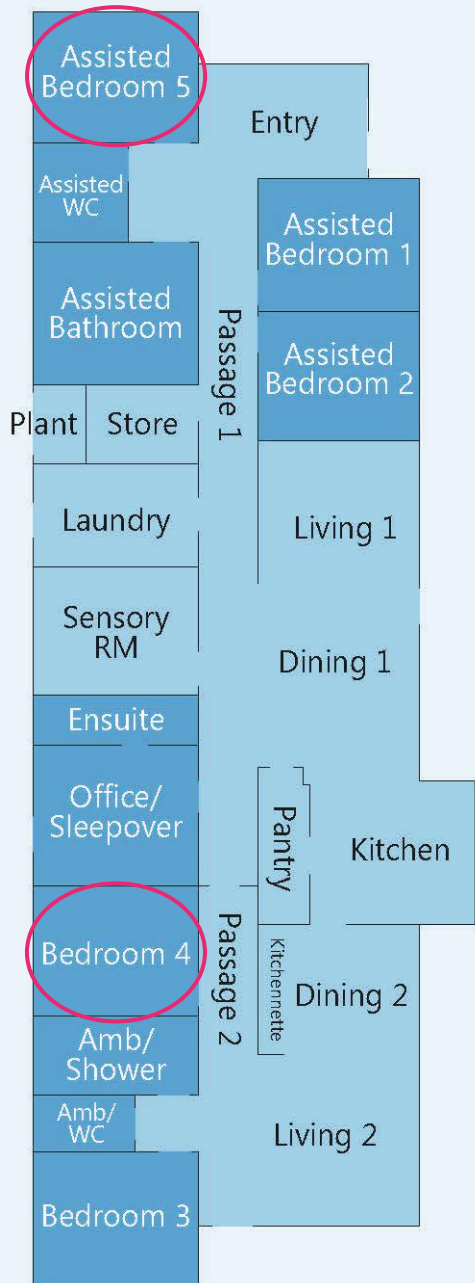

**Making an enquiry**

1300 472 673

[VacancyEnquiries@scopeaust.org.au](mailto:VacancyEnquiries@scopeaust.org.au)