



Supported Independent Living in Warrnambool

Property ID: 207



Bedrooms:
5



Bathrooms:
2



Property Owner:
Department of Families, Fairness and Housing (DFFH)



NDIS Funded SDA Design Category:
Improved Liveability



Support provided:
7 days per week with sleepover support model

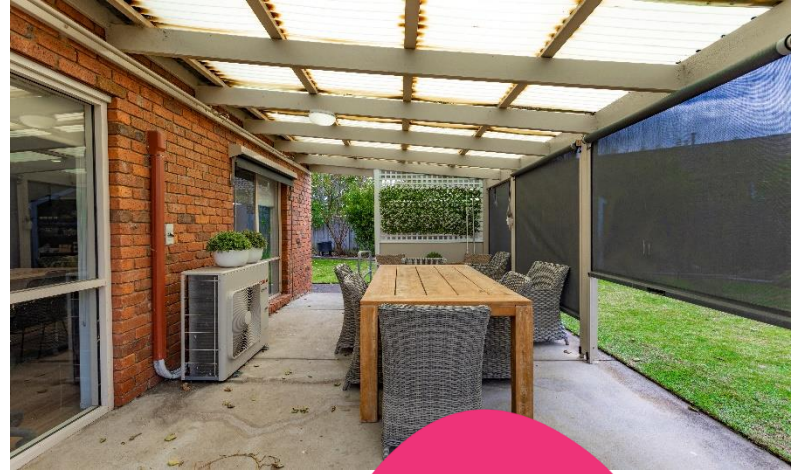

*Your
new home*

Enjoy living close to the beach in this bright, spacious home.

Features

- Featuring a kitchen with a meals area, living area and a lounge room.
- Two bathrooms (each with a toilet), a third separate toilet and a laundry.
- Ceiling tracks in both bathrooms and front living area.
- This house is wheelchair accessible, except in the laundry.
- An undercover veranda which can be used for entertaining family and friends.
- The property is owned by DFFH and staff support is provided by Scope.

Current residents

- Three male and one female resident aged between 56 and 69 years.
- The residents actively participate in their community with staff support, including going shopping, to the cinema, and out to the pub to see bands.
- They enjoy listening to music, cooking, and doing craft work.
- All residents attend a day program or 1:1 supported activities within the community.

Bedroom features

- Built-in robe.
- Evaporative cooling air and heating.
- Ceiling track in bedroom.

Nearby facilities

- Walking distance to bus stops and Northpoint Shopping Centre.
- Within a 5km radius there is a multiple pool complex, beach, hospital, medical clinic, CBD shopping centre, K-mart shopping complex, community hubs, religious centres, multiple parks, restaurants, hotels.

Interested in applying?

Before applying, make sure:

- The applicant is aged 18 years or over.
- The applicant has approved SDA eligibility and NDIA funding at the appropriate level.
- The applicant has the financial means to pay rent and utilities and is prepared to sign (or a representative to sign) a residential agreement.
- Specialist Disability Accommodation (SDA) category for this house is Improved Liveability.

Find out how this can be your new home

To apply, or for more details about this vacancy, contact DFFH on:

westvct@dffh.vic.gov.au

www.dffh.vic.gov.au

For SIL enquiries, contact Scope on:

1300 472 673

VacancyEnquiries@scopeaust.org.au

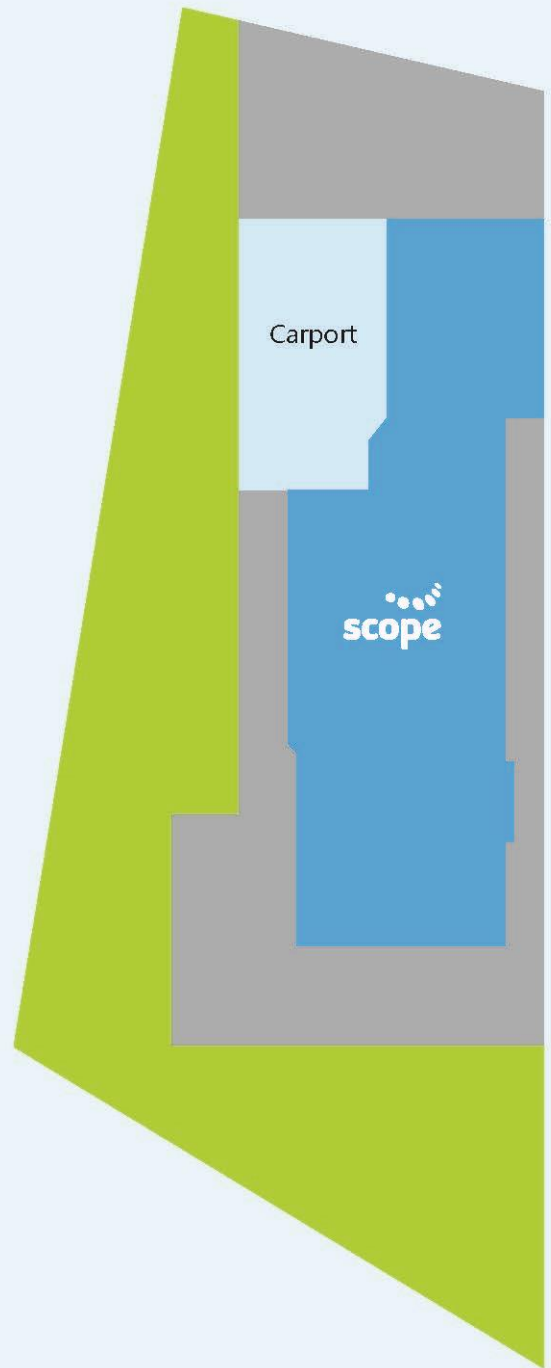
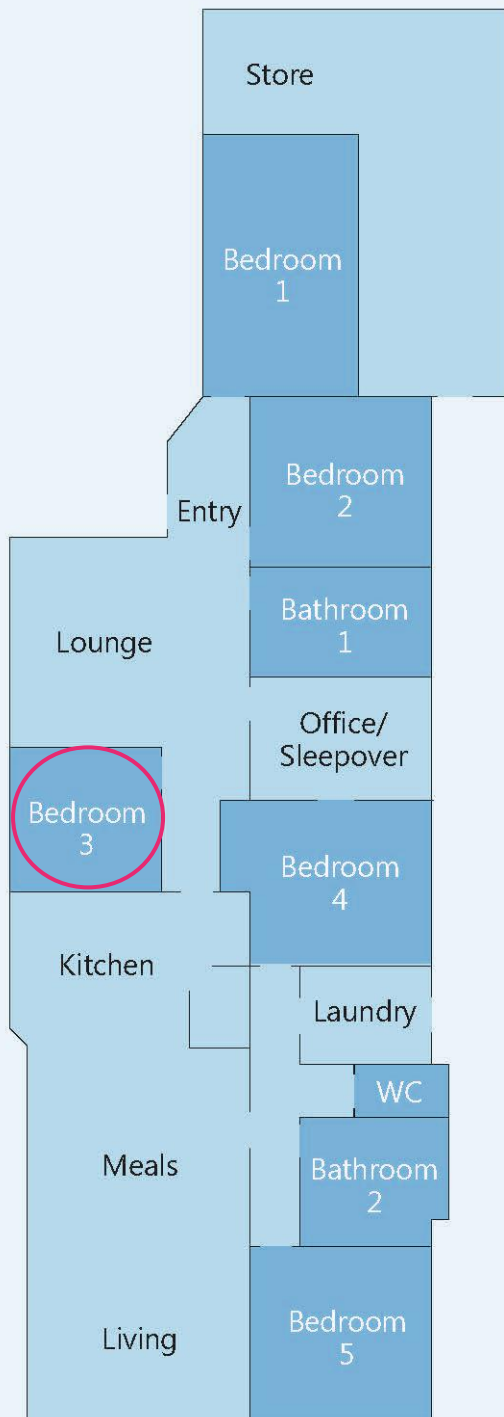

Making an enquiry

1300 472 673

VacancyEnquiries@scopeaust.org.au